



daisy
pool covers & rollers

Daisy Buddy Roller Installation Guide



At this stage the cover is trimmed, installed and on the pool water.

1. Centre assembled roller to pool
(roller is approx 150mm wider on each end). Align cord attachment (Feather Plugs) on the tube and mark about 100mm in from the end cut of the pool cover and punch a hole with the wad punch supplied.

2. Install eyelets.
Under the punched hole place the male half on the ground and female on the top. Tap together..

3. Secure cord to cover and roller.
Tie a loop at one end and attach to feather plug on roller. Thread other end through cover eyelet and tie off to cord adjuster or Bowline knot.

4. Repeat for all cord attachments.
If your pool has a curved end then you may only need to use 3-4 anchoring points.

5. Adjust the cords
with the cord adjuster so that the cover comes onto the roller tube evenly. Start from the centre and work out to the ends on both sides aiming to set cords to retrieve evenly.

Minor adjustments may be needed to fine tune the settings for smooth cover recovery.

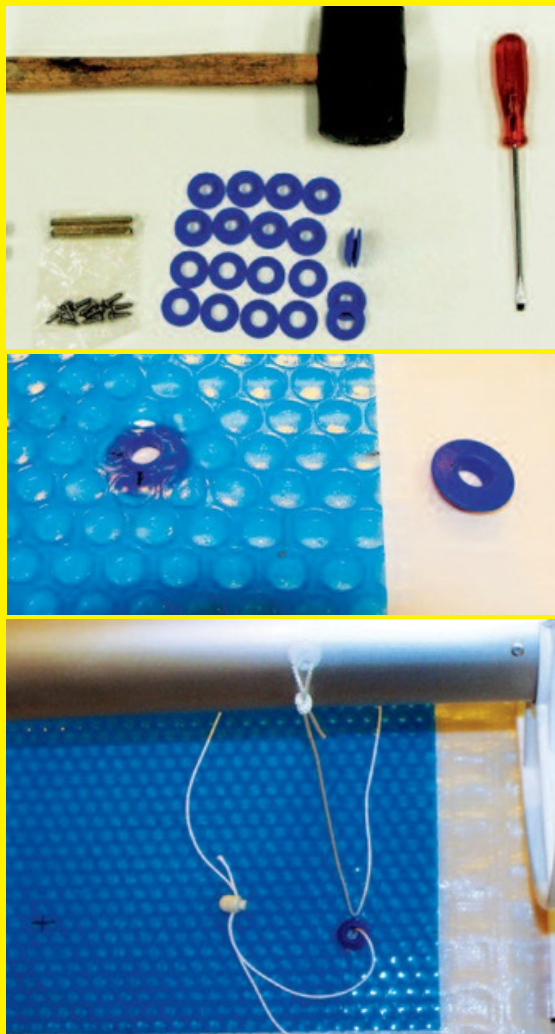

AUSTRALIA'S FAVOURITE.

1300 55 18 11 • daisypoolcovers.com.au

daisy
pool covers & rollers

Installation Procedure

UTC

Buddy Roller

UTC Above Ground

1) Extend the roller out evenly so that it is approximately 300mm wider than the widest point of the pool. Note: you may have to hand saw tubes down to size.

Lock the sections in place by drilling 4mm hole then inserting the three stainless steel self-tapping screws equal distance around the centre tube, 100mm in from the end, from each side. Place the tube evenly across the pool.

Buddy 75 has the insert option to make the 50mm crank fit into the 75mm 2 piece tube



Roller Kit Includes
One Tube Kit
3 X tubes: 2 one size, 1 Joiner Two Handles (crank)
Two End Yokes
Twelve Screws
One OverCover Kit

1 X Overcover Sheet, 2 X stretch straps, 6 X white eye-lets
Cover Connection Kit
TenEyelets
Ten male / Ten female
One Eyelet Punch
Ten Feather Plugs
Ten 2metre Cords

Equipment Needed

Rubber Mallet
Philips Screwdriver
Block of wood (for hole punching)
Drill - cordless if working around pool water
Hammer

2) Slide the crank into each end of the roller. Using the indicator marks on the outside of the crank, drill 3 x 4mm holes and install the three screws on each end, 35mm in from the end of the tube.

3) Put the Yoke into the roller foot. Press the anti-skid plugs into the holes under the foot.

4) With you roller sitting at right angle to your pool, and evenly centred, mark the centre of the roller and drill a 6mm hole. Measure out 600mm from each side of this hole and drill on the same centre line. Continue this procedure until you have reached the outside of your pool.

5) Tap your feather plugs into these holes

6) Install to cover instructions overleaf.

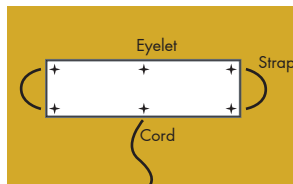

OverCover must be on rolled up Daisy Pool Cover for UV protection.

How to put your overcover together

1. Cut the overcover to size ie. over the roller between the handwheels
2. Make a hole in each corner of the overcover and the centre of each side - as per diagram
3. Place the male blue eyelet section on the ground
4. Place the hole in the overcover over the male eyelet section.
5. Place the female section on top of the male section and tap together with a hammer
6. Repeat for the other 5 holes
7. Tie the cord to one of the middle eyelets
8. Place the metal hook of the elastic strap at the end of the eyelet and close it with pliers so it cannot come off.
- Note: Never overextend elastic straps, as injury may result
9. Repeat for the other end of the strap
10. Repeat 8&9 for the other end of the overcover.
11. Place the overcover on top of the roller and wrap one strap around the handwheel
12. Place the other strap over the handwheel
13. Tie the middle cord.
14. Your overcover is now installed.

Always use your overcover when your cover is rolled up onto your roller and off the pool water.

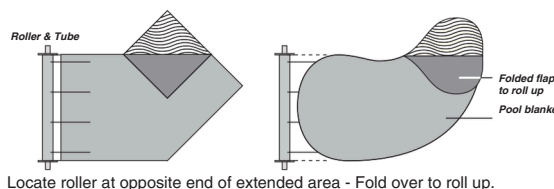

Locate roller at opposite end of extended area - Fold over to roll up.

Buddy

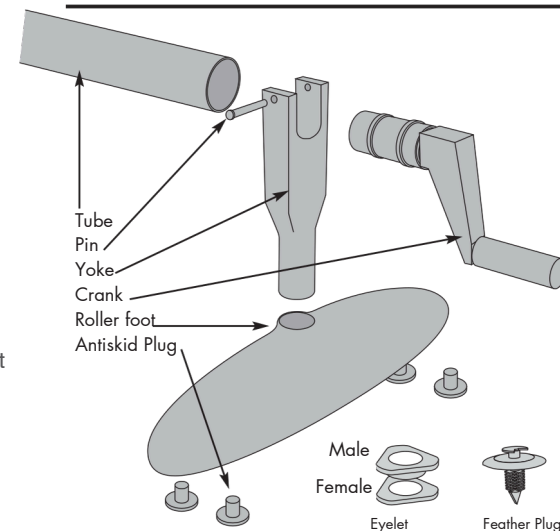

Above Ground Kit

