

Caddy Fixed

Installation Instructions

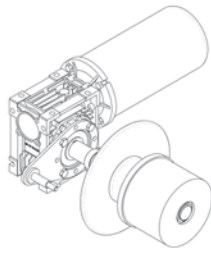

1530 - Motor & Gearbox With Unique Drive Disengage

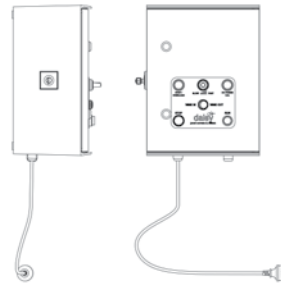

1520 - Control Cabinet

Caddy Fixed

Part List

- 2 x Frames (the same process is used for any of the Caddy Fixed models)
- 1 x tube with square end slug + disengage end slug
- 1 x 500mm handwheel + adaptor
- 1 x Commercial caddy drive motor
- 1 x control cabinet
- Hardware including - Bolts/Washers

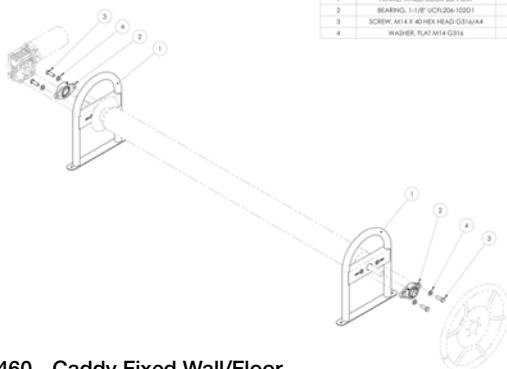

PARTS LIST			
ITEM NO.	DESCRIPTION	PART NUMBER	QTY
1	FRAME, WALL/FLOOR SUPPORT	1505-101	2
2	BEARING, 1-1/8" UCFL306-102D1	1505-102	2
3	SCREW, M14 X 40 HEX HEAD G316/A4	1505-104	4
4	WASHER, FLAT M14 G316	1505-105	4

1460 - Caddy Fixed Wall/Floor

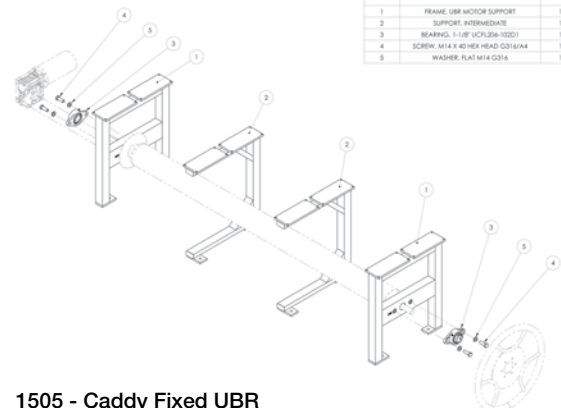

PARTS LIST			
ITEM NO.	DESCRIPTION	PART NUMBER	QTY
1	FRAME, UBR MOTOR SUPPORT	1505-101	2
2	SUPPORT, INTERMEDIATE	1505-102	2
3	BEARING, 1-1/8" UCFL306-102D1	1505-102	2
4	SCREW, M14 X 40 HEX HEAD G316/A4	1505-104	4
5	WASHER, FLAT M14 G316	1505-105	4

1505 - Caddy Fixed UBR

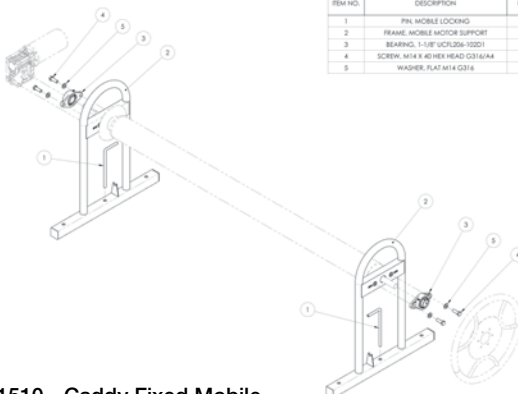

PARTS LIST			
ITEM NO.	DESCRIPTION	PART NUMBER	QTY
1	PKT, MOBILE LOCKING	1510-101	2
2	FRAME, MOBILE MOTOR SUPPORT	1510-102	2
3	BEARING, 1-1/8" UCFL306-102D1	1505-102	2
4	SCREW, M14 X 40 HEX HEAD G316/A4	1505-104	4
5	WASHER, FLAT M14 G316	1505-105	4

1510 - Caddy Fixed Mobile

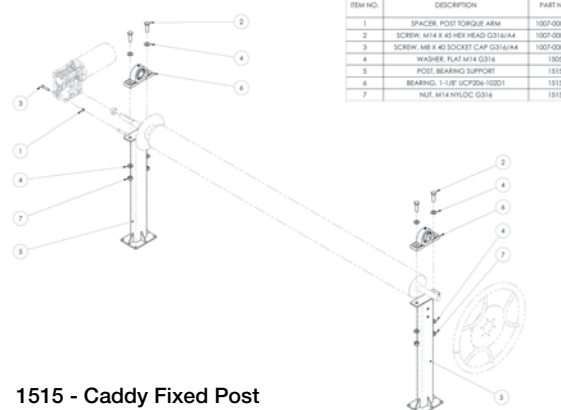

PARTS LIST			
ITEM NO.	DESCRIPTION	PART NUMBER	QTY
1	SPACER, POST TORQUE ARM	1007-00011-P355	1
2	SCREW, M14 X 40 HEX HEAD G316/A4	1007-00011-P415	4
3	SCREW, M8 X 40 SOCKET CAP G316/A4	1007-00011-P419	1
4	WASHER, FLAT M14 G316	1505-105	8
5	POST BEARING SUPPORT	1515-101	2
6	BEARING, 1-1/8" UCFL306-102D1	1515-102	2
7	NUT, M14 NYLOC G316	1515-103	4

1515 - Caddy Fixed Post

Step 1

Unboxed, ready to assemble.



Step 2

Put drive end slug on ground with shaft facing up. Place collar spacer over shaft and slide all the way home.



Step 3

Put frame with bearing installed over shaft - evenly slide shaft onto bearing



Step 4

Slide keyway into groove on shaft of disengage end slug, gently tap into place.



Step 5

Keyway in home position.



Step 6

Line up and slide gearbox + motor assembly over the key and shaft assembly.

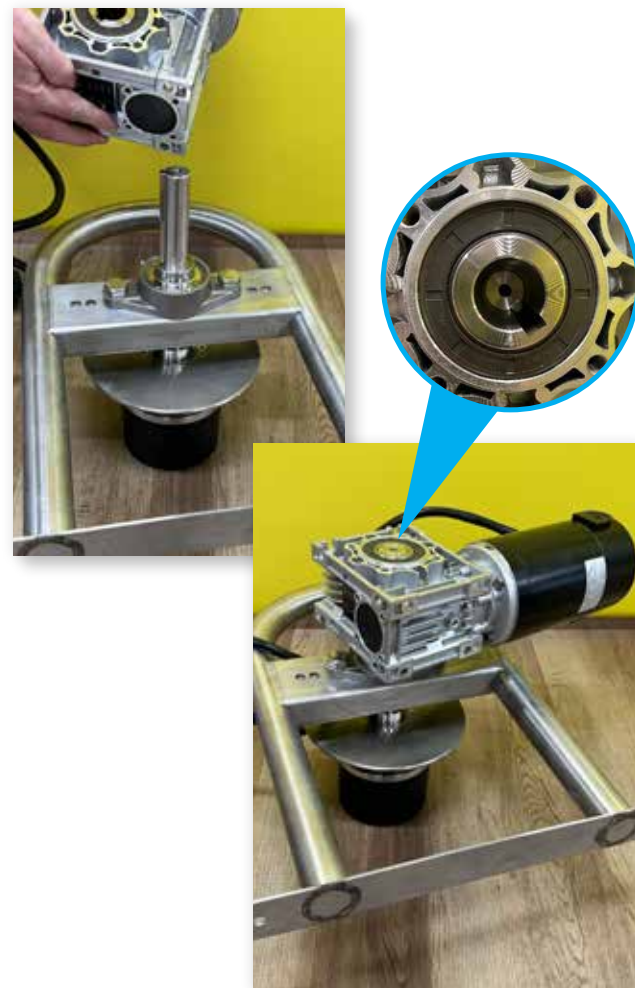

Step 7

Install retaining bolt and washer.

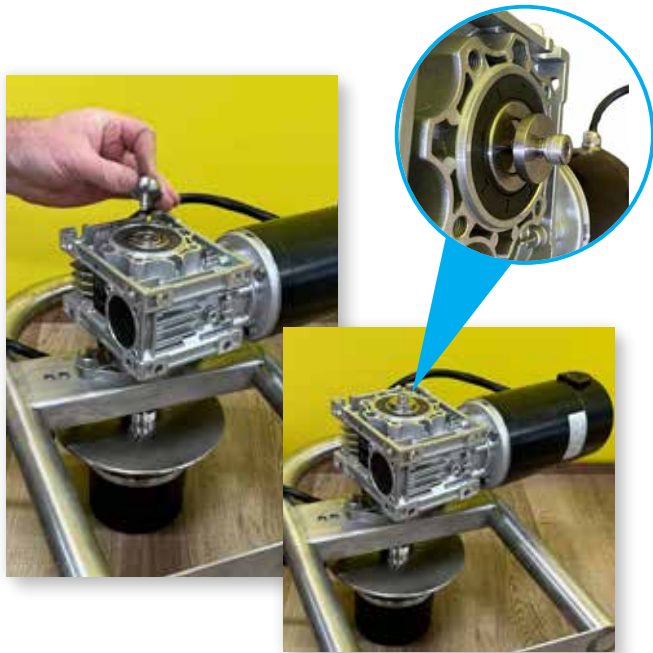

Step 8

Install spacer and M8 x 70mm motor torque bolt, orientate motor to where you want it facing (aim for cable to be at bottom).

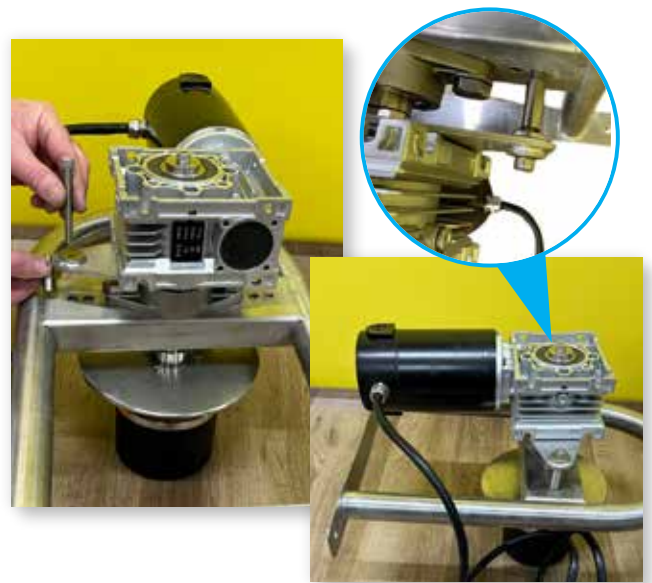

Step 9

Put roller and frames in position.



Step 10

Line up pre assemblies dots on drive motor end slug to tube.



Step 11

Slide end slug into tube, align holes.



Step 12

Install 6 x M8 retaining bolts and washers with thread lock.



Step 13

Tightening retaining bolts.

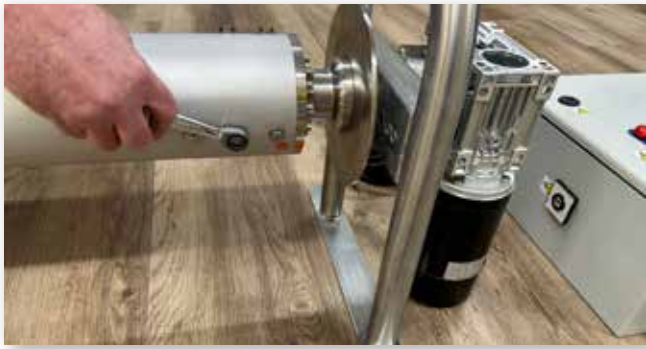

Step 14

Slide slave end frame over the other end of the tube's end slug.



Step 15

Slide collar over shalf, tighten grub screw with Allen Key.



Step 16

If the handwheel is not being installed, skip to **Step 19** to connect control box.



Step 17

If handwheel is to be installed, line up square drive and slide handwheel adapter over square drive.



17.1. Line up handwheel to the square drive.



17.2. Slide handwheel onto end slug shalf.

Step 18

Install M5 x 50mm retention bolt and tighten nyloc nut.



18.1. Use bolt to secure handwheel.



18.2. Tighten with allen key.



Assembly Progress

This picture shows progress of assembly.



Step 19

Next step is to connect motor wires into control cabinet. **Note:** to reverse motor drive (to have directional control buttons working desired direction), simply reverse the DC motor wires.



Step 20

Use key to unlock cabinet.



Step 21

Undo cable grommet in bottom of cabinet and slide grommet onto wires.



Step 22

Insert the wires into cabinet.



Step 23

Open Control unit cabinet.



Step 24

Locate motor wire position with label.

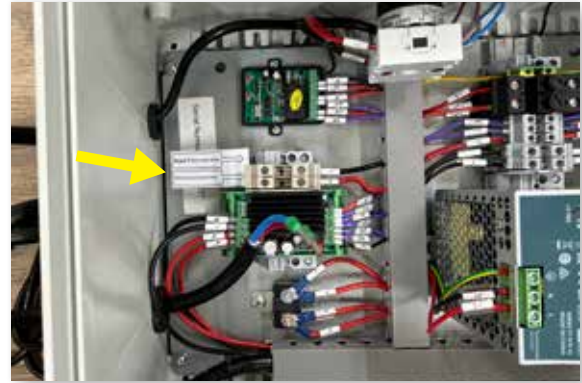

Step 25

Wires are through cabinet. In this picture, 1 red wire, 1 blue wire.

Note: Labels motor wires as per arrow.

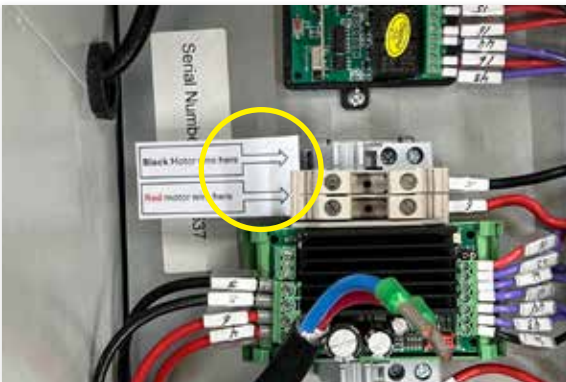

Step 26

In this instance, blue wire will be black wire.



Step 27

Loosen screws with small flat head screwdriver.



Step 28

Connect wires as per wiring label. Again, to reverse DC motor drive (for buttons) simply swap motor wires around



Step 29

Tighten screw.



Step 30

Tighten wire grommet on bottom of cabinet to secure, ensuring the cable inside is not tight.



Step 31

Close cabinet and lock with key.



Step 32

Plug power lead into socket using metal key provided. Switch cabinet to **ON** position.



Step 33

Key in **ON** position and until powered up. Wait at least 30 seconds from turning on to operation of motor. (Will error if immediate motor drive is pressed).



Step 34

You may have to press **STOP** to reset unit.



Drive Disenage

To disengage place both hands on disengage plate, press away from roller and turn as indicated, (teeth out) to re-engage, turn and release.



Drive Engaged (teeth meshed)

See video of how to operate here: youtu.be/9XcUrQ9Q-mc



Mount roller frames and control box as required. See video of to operate here: youtu.be/ldpOVDpc9HA



Note: For safety the drive buttons will only operate the motor while presses, the motor will stop driving when the button is released to operate, (copy info from video) and show controll box image with arows and labels.



Control unit with remote control

If the handwheel has not been installed. In order to use handwheel during manual operation. Disengage motor by pulling disengage disk toward frame and turn slightly to lock.

Step 1

Disengage drive.



Step 2

Note: Square end on end slug shank. This is for handwheel adaptor that has *square insert*.



Step 3

Slide handwheel onto end slug shaft.



Step 4

Use M5 x 50mm bolt/nyloc nut to secure handwheel onto end slug, insert bolt.



Step 5

Tighten bolt and nut.



As per picture.

Tools Required

- Allen Key
- 8mm Spanner



AUSTRALIA'S FAV♥URITE.

1300 55 18 11
daisypoolcovers.com.au



PROUDLY AUSTRALIAN MADE